

EVOLUTION WAND

Carpet Scrub Wand

AW97

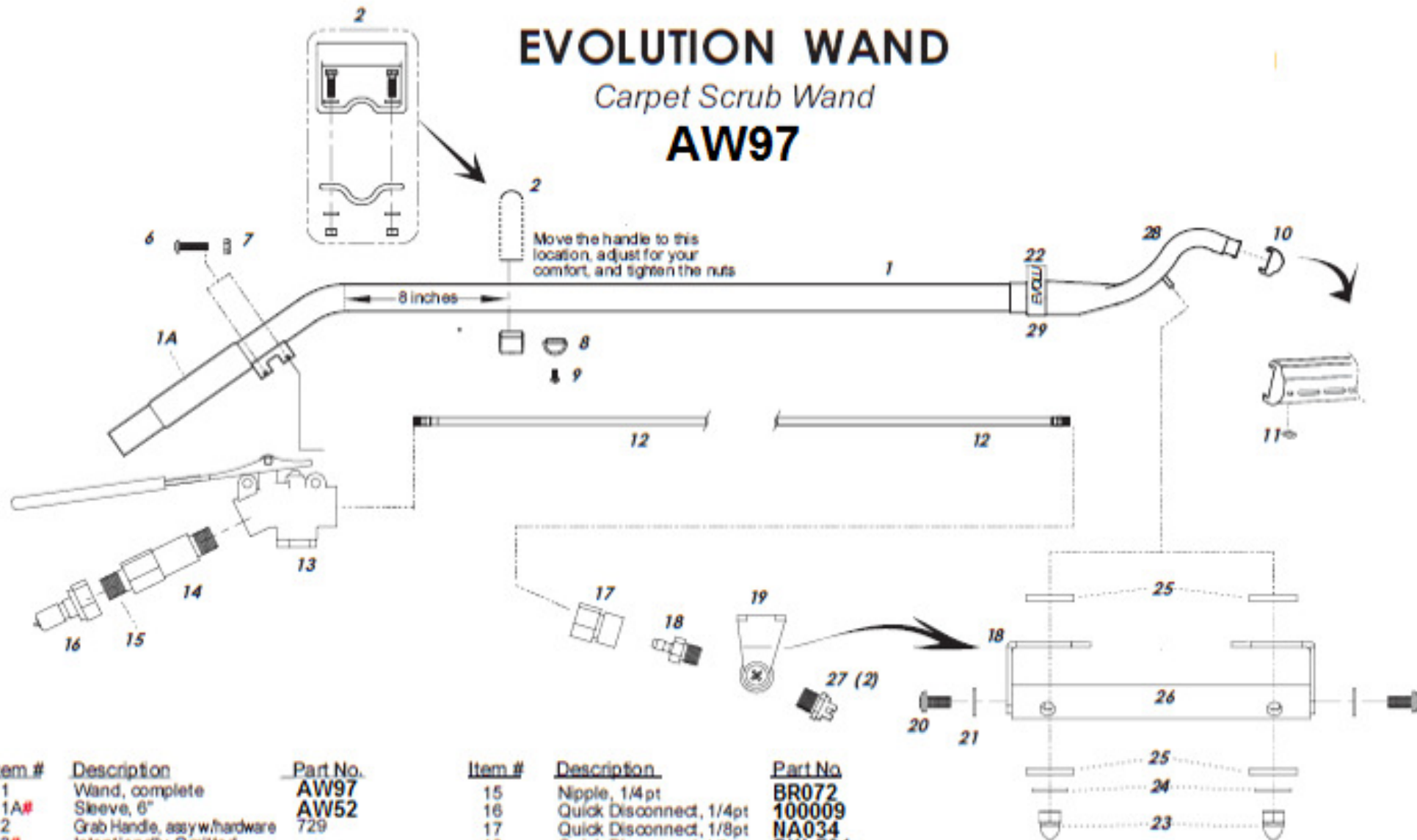

Item #	Description	Part No.
1	Wand, complete	AW97
1A#	Sleeve, 6"	AW52
2	Grab Handle, assy w/hardware	729
3#	Intentionally Omitted	
4#	Intentionally Omitted	
5#	Intentionally Omitted	
6	Screw, 8-32 X 1-1/8"	1156
7	Nut Hex Nyl Loc SS 8-32	NM5793
8	D-ring	1394
9#	Bolt, 10-32 X 3/8"	1588A
10	Glide and set screw	FP638
11	Set Screw, 10-24 X 3/8" S/S	1591
12	Solution hose assembly	FP557
13	Valve, complete, 1200 PSI	AW791
	Rebuild kit, for valve	AW794
14	Filter, in-line	PKLD28

Item #	Description	Part No.
15	Nipple, 1/4pt	BR072
16	Quick Disconnect, 1/4pt	100009
17	Quick Disconnect, 1/8pt	NA034
18	Quick Disconnect, 1/8 pt	PKLF01
19	Bracket, spray tube	2099
20	Bolt, 10-32 X 3/8"	1588A
21	Washer, flat	87036A
22	Strap, hook & loop	1586
23	Nut, acorn, S/S	56002491
24	Washer, 1/4" ID X 1" OD	56009060
25	Washer, rubber	218
26	Manifold	2098
27	Soray Tip, V-jet, brass	B607
	11001 for 500 PSI	
28	Replacement Head	FP588
29#	Label, Evolution	3060A
[]#	Cap, Black Vinyl 1-1/2 ID X 1"	S46
[]#	Cap Black Vinyl, 0.5" ID	S47

= Revised or new since last update.
[] = Not Shown

NOTE: This tool is suitable only for use with water or chemical with a pH between 5 and 10